

Thank you for purchasing this Factory Service Manual CD/DVD from [servicemanuals4u.com](http://servicemanuals4u.com).

Please check out our eBay auctions for more great deals on Factory Service Manuals:

[servicemanuals4u](http://servicemanuals4u.com)

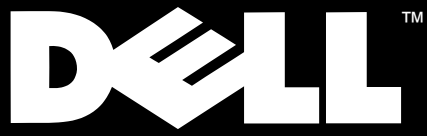

Dell™ Latitude™ LT Systems

**PARTS REMOVAL AND  
REPLACEMENT GUIDE**



---

**Information in this manual is subject to change without notice.  
© 1998 Dell Computer Corporation. All rights reserved.**

Reproduction in any manner whatsoever without the written permission of Dell Computer Corporation is strictly forbidden.

Trademarks used in this text: *Dell*, the *DELL* logo, and *Latitude* are trademarks of Dell Computer Corporation.

Other trademarks and trade names may be used in this document to refer to either the entities claiming the marks and names or their products. Dell Computer Corporation disclaims any proprietary interest in trademarks and trade names other than its own.

December 1998 P/N 8829D

# DISASSEMBLY AND REASSEMBLY

- Here is the procedure for disassembling the Latitude LT computer. The product should be reassembled in the reverse order from disassembly.
- The description of some components that can be disassembled and reassembled relatively easily may be omitted.
- Before trying to disassemble the product, make sure of the wiring and the positions of the tapes and Mylars attached.

## 1. Keyboard, LCD unit

- a. Remove the keyboard unit ③, upper cabinet ④, and LCD unit ⑫ from the lower cabinet ⑬, following the flow chart.

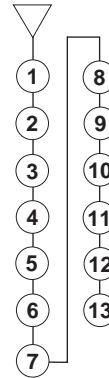
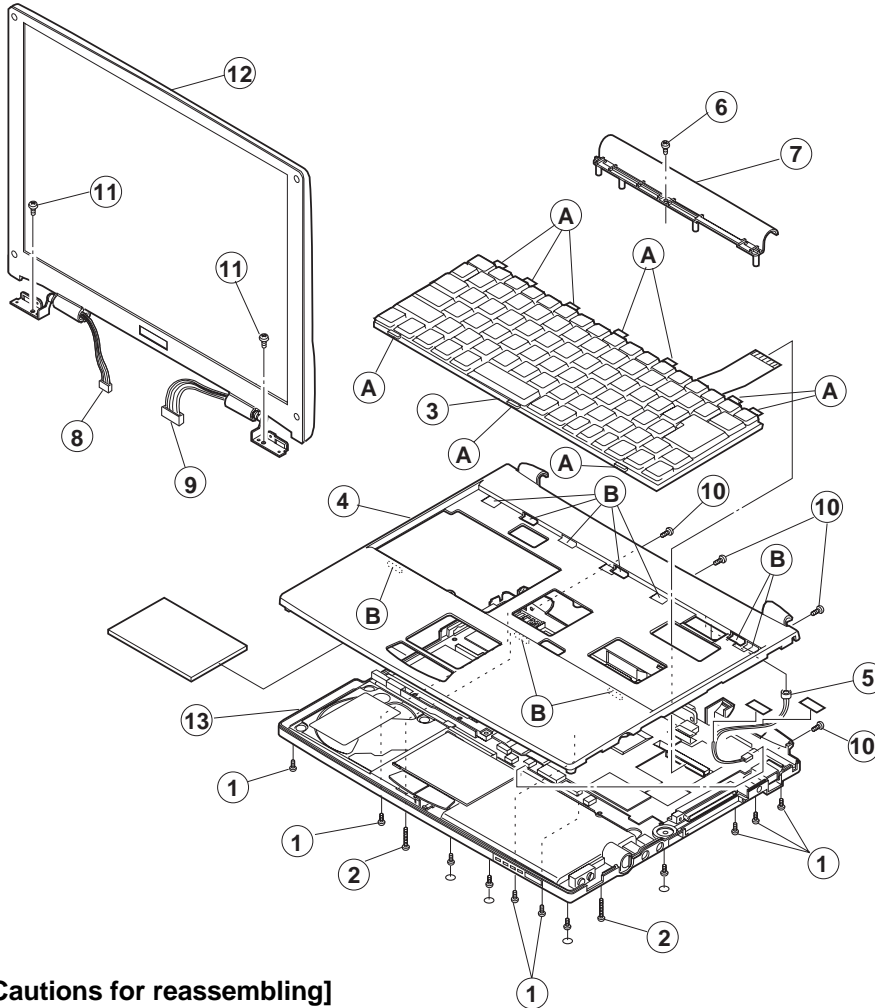

### Parts List

No.	Part Name	Q'ty
1	Screw (M2 × 5)	8
2	Screw (M2 × 8)	2
3	Keyboard unit	1
4	Upper cabinet	1
5	Mike unit	1
6	Screw (M2 × 6)	1
7	Indicator cover	1
8	Indicator cable	1
9	LCD cable	1
10	Screw (M2 × 5)	4
11	Screw (M2 × 4)	2
12	LCD unit	1
13	Lower cabinet	1

### [Cautions for reassembling]

- The indicator cable ⑧ should be wired by pushing it in the direction indicated by the arrow.

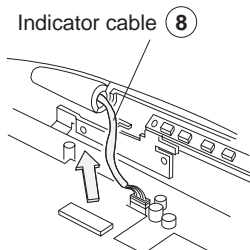

- After attaching indicator cover ⑦, check that the pawl on the rear side is securely engaged.
- When installing the keyboard unit ③, align the projection of the unit (item A) with the recess in the upper cabinet (item B).

## 2. Inverter PWB, LCD unit

- Remove the LCD unit from the lower cabinet, following the procedure 1-a.
- Remove the LCD panel (4), inverter PWB (10), and LCD unit (11), following the flow chart.

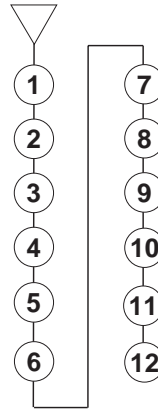
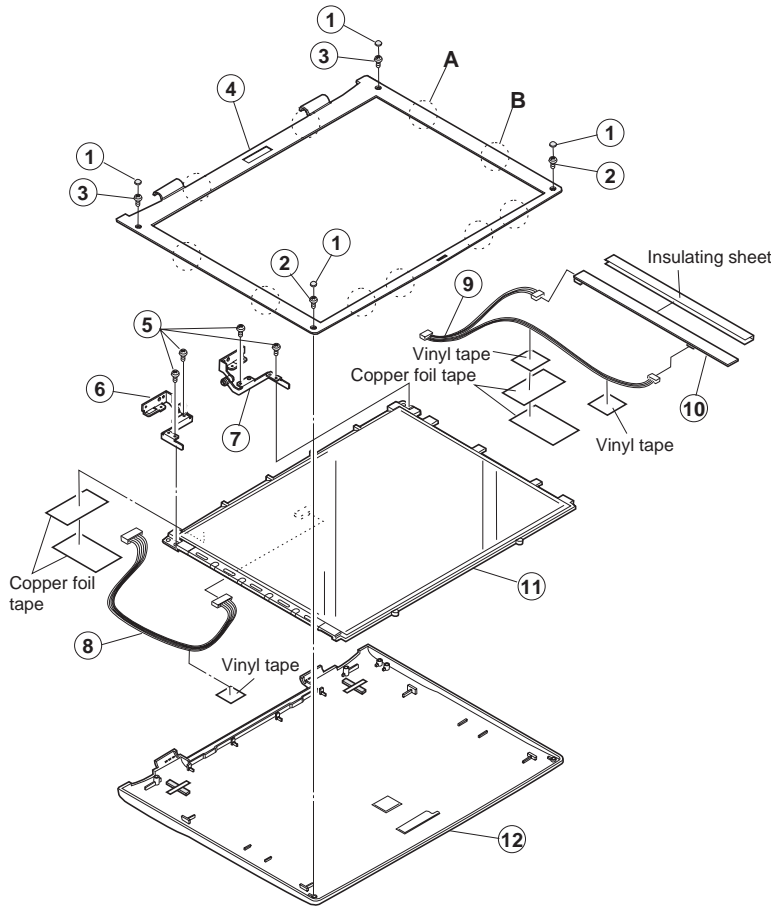

### Parts List

No.	Part Name	Q'ty
1	Screw-covering sheet	4
2	Screw (M2 × 2.8)	2
3	Screw (M2 × 6)	2
4	LCD panel (display front cabinet)	1
5	Screw (M2 × 6)	4
6	Hinge R	1
7	Hinge L	1
8	Main cable	1
9	Inverter cable	1
10	Inverter PWB	1
11	LCD unit	1
12	LCD cover assembly	1

### [Cautions for reassembling]

- The LCD unit should be wired as follows:
  - After attaching the vinyl tapes, attach four copper foil tapes in the order of A to D.
  - Make sure to attach the copper foil tape A to the screw A.
  - Make sure to attach the copper foil tape C to both the screw B and backlight chassis.
  - Use caution not to block the holes A and B when attaching vinyl tapes A and B.
  - Make sure to pass the main cable between the capacitor and the resistor.
  - The main cable should be passed to the left side of the rib A and the inverter cable to the right side of the rib B.

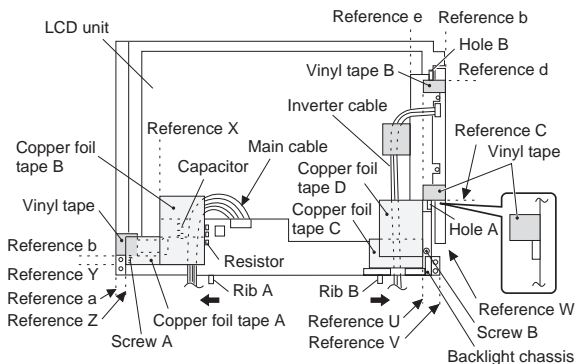

- Attach the insulating sheet and inverter spacer to the inverter PWB, using the following cautions:

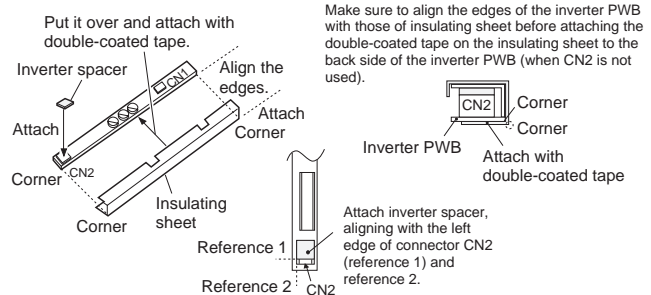

- Use caution not to get the high-voltage cable caught when tightening the screw for the hinge L (7).

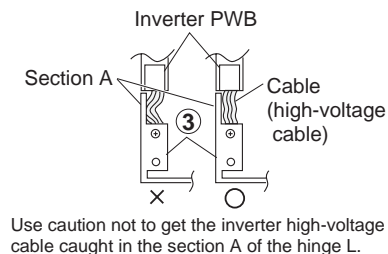

- When setting the LCD panel (4) onto the LCD cover assembly, first fit the A and B of the 10 hooks indicated by dotted lines on the LCD panel (4). Use caution not to get the inverter insulating sheet caught.

### 3. Lower cabinet, built-in battery replacement

- Remove the keyboard, upper cabinet, and LCD unit from the lower cabinet, following the procedure 1-a.
- Remove the built-in battery, HDD unit assembly, and glide point PWB, following the flow chart.

[Note] When replacement of built-in battery is required, follow the steps ① to ⑨ of the flow chart.

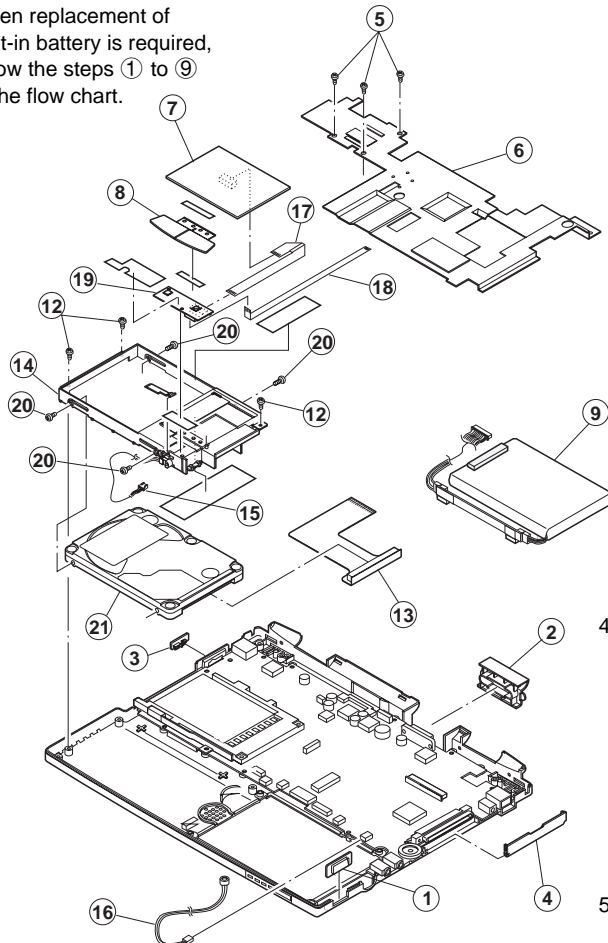

#### Parts List

No.	Part Name	Q'ty
1	IR filter	1
2	D-sub connector cover	1
3	Power supply switch button	1
4	IO connector cover	1
5	Screw (M2 × 8)	3
6	Heat dissipation plate assembly	1
7	Glide point pad assembly	1
8	Glide point button	1
9	Built-in battery assembly	1
12	Screw (M2 × 4)	1
13	HDD FPC	1
14	HDD unit assembly	1
15	Shut switch cable	1
16	Mike cable	1
17	Glide point FFC (fine)	1
18	Glide point FFC (thick)	1
19	Glide point PWB	1
20	Screw	4
21	HDD unit	1

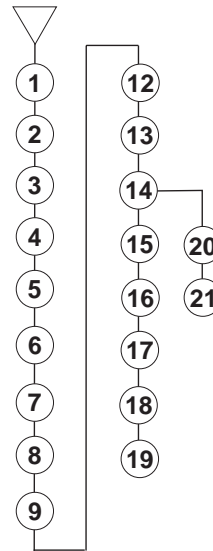

- Connect the HDD FPC ⑬ to the rightmost pin of the HDD.

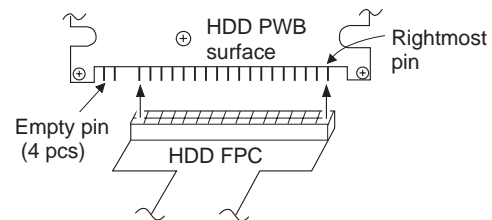

- The shut switch cable ⑮ and mike cable ⑯ should be wired as shown below.

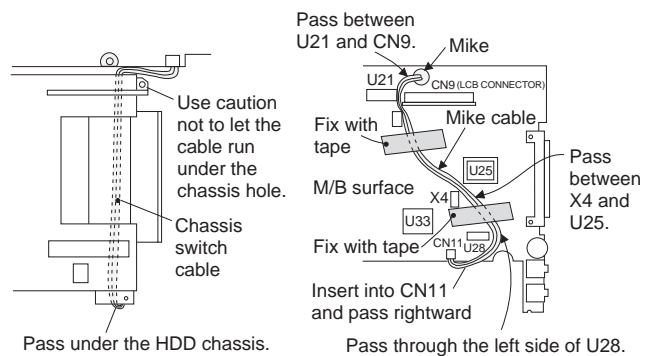

#### [Cautions for reassembling]

- Attach the glide point-covering sheet to the glide point PWB ⑱, using the following references:

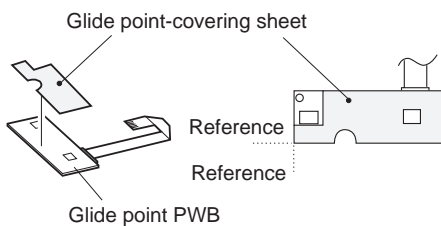

- Connect shut switch cable ⑮ to connector CN23 of the main PWB before installing HDD unit assembly ⑭. Insert shut switch cable ⑮ connector in the direction shown below.

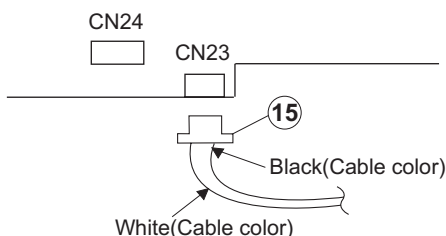

- Connect the shut switch cable ⑮ to the main PWB CN23 before installing the HDD unit ⑭.

- Connect glide point FFC (large) to glide point pad assembly ⑦. Install glide point pad assembly ⑦ to HDD chassis.
- Install power supply switch button ③ as shown below.

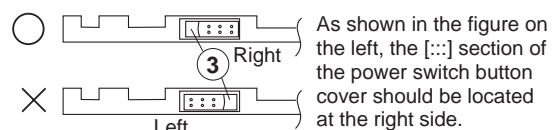

Make sure the button is inserted in parallel to the cabinet. (Otherwise, the rib might be broken leading to poor sliding of the button.)

## 4. Lower cabinet

- Remove the keyboard, upper cabinet, and LCD unit from the lower cabinet following the procedure 1-a.
- Remove the built-in battery, HDD unit and others, following the procedure 3-b.
- Remove the lithium battery, speaker, IR-PS PWB and main PWB, following the flow chart.

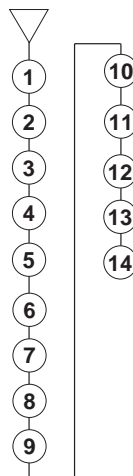
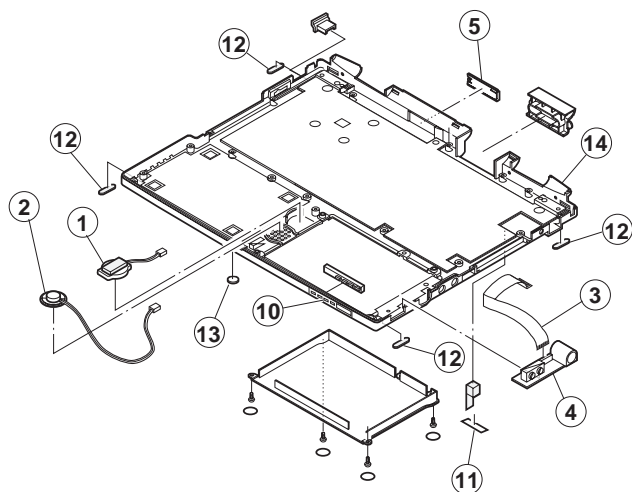
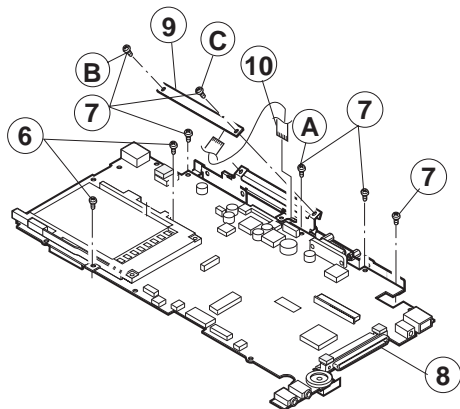

## Parts List

No.	Part Name	Q'ty
1	Lithium battery	1
2	Speaker	1
3	FFC (for IR-PS PWB)	1
4	IR-PS PWB	1
5	Expansion battery connector cover	1
6	Screw (M2 × 2.8)	2
7	Screw (Ms × 4)	6
8	Main PWB assembly	1
9	LED PWB	1
10	LED FFC	1
11	Reset label	1
12	Rubber leg (oval)	4
13	Rubber leg (circle)	1
14	Lower cabinet assembly	1

### [Cautions for reassembly]

- Attach IR-PS PWB insulating sheet as shown in the figure below.
- When setting main PWB assembly ⑧ to the lower cabinet, insert the knob and audio jack first.
- Secure the main PWB assembly ⑧ with 6 screws. The screws should be tightened in the order of A to C. Use caution not to damage LED FFC.

Attach IR-PS PWB insulating sheet, using rib A as a reference.

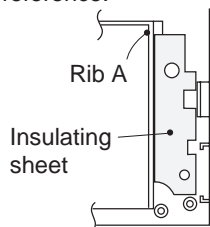



Printed in the U.S.A.

**DELL**™



\* 8 8 2 9 D \*

P/N 8829D

[www.dell.com](http://www.dell.com)