



**Safari<sup>®</sup> NSX/20**  
notebook computer

# Where's Networked Computing Going?

Mobile Networked Computing is the extension of AT&T's Networked Computing strategy to include *portable clients*. The AT&T Safari® NSX/20 notebook computer goes beyond conventional portables in three important areas:

- **Ease of Use**
- **Extended Battery Operation**
- **Mobile Communications**



**AT&T's initial portable client, Safari notebook computer, provides networked desktop performance in a portable package.**

This seven pound notebook utilizes a 20 MHz 80386SX processor, and is offered with a choice of 2 to 6MB of RAM and 40MB hard disk or 4 to 8MB of RAM and 80MB hard disk.

Both systems include a 1.44MB floppy disk drive and portable mouse.

## Ease of Use

The Safari notebook computer is ready to use right out of the box. You can skip the documentation. Simple instructions are printed on the inside flap of the box.

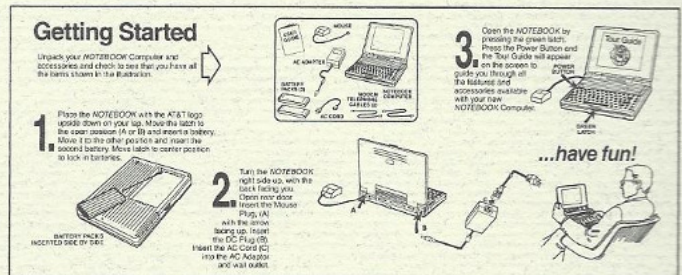

DOS®, Windows™, Access PLUS™ for Windows electronic mail software and utilities are already loaded on the hard disk, ready to perform useful work right out of the box.

**No need to format the hard disk or load multiple floppy disks.**



When you press the power button, the "plug and play" feature will take you directly to the Safari TourGuide, an interactive Windows-based tutorial demonstrating all of the advanced features of the NSX/20.

Load your favorite applications or use the ones already loaded on the Safari computer: Windows word processor, communications, drawing, calculator, calendar, card file, clock, notepad and Access PLUS software.

We even provide an on-line warranty registration using Access PLUS and the integrated modem. Your registration qualifies you for valuable free Safari computer accessories.

# ...Any Where you want!

## Extended Battery Operation

The Safari NSX/20 notebook computer was designed by portable users who understand the need for extended battery operation. Careful attention went into the selection of low power consumption components, sophisticated power management and the application of advanced high energy/density batteries. We customized Windows to cooperate in this power management scheme as well as enhancing cursor visibility.

The dual battery pack provides up to 6 hours of battery operation — non-stop computing from San Francisco to New York. Carry along a 12 ounce spare battery and add another 3 hours.



A separate "System Window" graphic display shows individual battery condition along with the status of other sub-systems and keyboard locks. You can view the System Window with the NSX/20 open or closed.

When indicated, you can pop in the spare battery without turning off the power or interrupting your application.

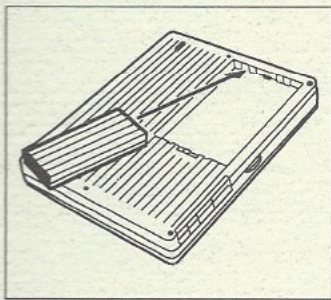

**Battery packs inserted side by side.**

If AC power is conveniently available, you can use the compact 16 ounce AC adaptor provided with your NSX/20 to power the computer and/or charge the batteries.

Ignore power failures and brown outs because Safari computer's uninterruptable power supply (UPS) feature will provide uninterrupted computing while desktop computers all around you are out of commission until power is restored.

## Mobile Communications

The Safari computer is at home on an office desktop connected to the departmental network with an optional pocket LAN adaptor or, on the road, connected to the dial network via the integrated 2400bps modem. This advanced modem, featuring MNP<sup>®5</sup> protocol, is factory installed and tested. Simply customize the Windows Terminal program to meet any special requirements of your host. One more example of our "plug and play" approach.

**Pocket LAN adaptors are available for 10Base T, Ethernet and Token Ring.**

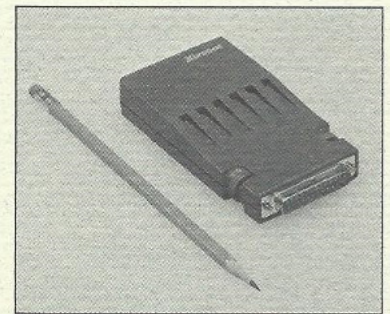

The NSX/20 is a certified client on AT&T StarGROUP<sup>®</sup> LAN Manager and Novell networks.

Need to send a Fax? The NSX/20 and AT&T Mail make it easy and dependable. Busy signals are not a problem. AT&T Mail will keep on trying until the Fax is delivered, allowing you to get back on the road.

Need to get your messages while on the road? The Safari NSX/20 Wireless Mailbox provides wireless receipt of mail messages, wherever you are.

## Mobile Networked Computing— Any Time, Any Where.

## Safari NSX/20 Notebook Computer Technical Specifications

**Top View**

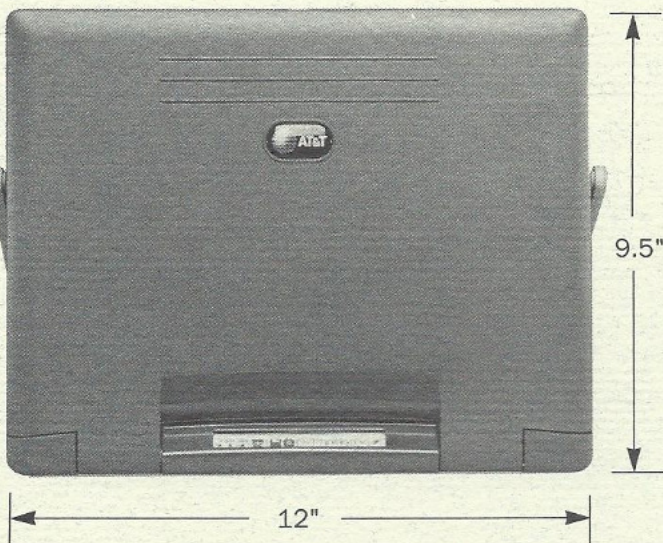

**Front View**

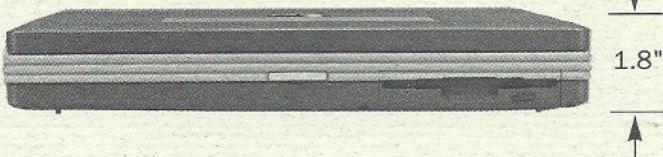

**Rear Panel Connections**

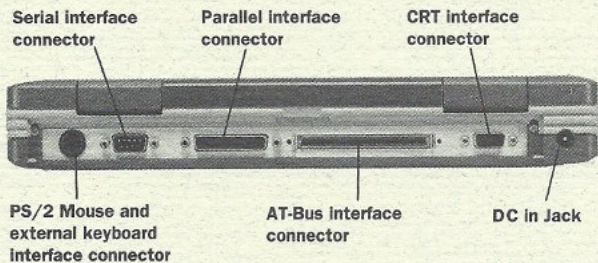

DOS and Windows are registered trademarks of Microsoft Corporation. Safari is a registered trademark of Safari Systems, a venture of AT&T and Marubeni. Access PLUS is a registered trademark of AT&T. All other trade names referenced are the service mark, trademark, or registered trademark of the respective manufacturers.

The AT&T Safari NSX/20 notebook computer includes a one-year mail-in warranty. In addition, toll-free system support is provided for trouble isolation and disposition for one year from date of installation.

For further information, or the location of an AT&T Computer Systems Authorized Reseller, call 1 800 247-1212

<b>Microprocessor</b>	80386/SX 20MHz
Coprocessor option	80387/SX 20MHz
<b>Memory</b>	
RAM	2 to 6MB (40MB hard disk model) 4 to 8MB (80MB hard disk model)
Memory Expansion	Optional 2 or 4MB Memory Module
ROM	128 KB
<b>LCD Display</b>	10" diagonal Triple Super Twist
Compatibility	VGA, EGA, CGA, MDA (external VGA or SVGA)
Dot Matrix	640 x 480 pixels (1:1 pixel aspect 12:1 contrast ratio)
Text Mode	25 lines x 80 columns or 25 lines x 40 columns
Graphic Mode	640 x 480, 640 x 350, 640 x 200, 320 x 200 pixels
Backlight	Electro Luminescent
Reflectivity	Non-glare surface
<b>Hard Disk</b>	40MB, 2.5" form factor or 80MB, 2.5" form factor
Average Access	19ms
Transfer Rate	10 Megabits/second
<b>Floppy Disk</b>	1.44MB, 3.5" form factor
Transfer Rate	500/250KB/second
<b>Interfaces (I/O)</b>	
Serial	Two RS-232C (one dedicated to internal modem)
Parallel	Centronics
External Video	VGA or SVGA
External Keyboard	PS/2 compatible Mouse, Keyboard or Keypad
Expansion	External AT Bus port
Communications	Two RJ11 Modem connectors (telephone and line)
<b>Modem</b>	
Transmission Rate	2400bps, CCITT V.22bis
Error Correction	CCITT V.42, MNP Class 1-4
Data Compression	MNP Class 5
Command Set	Hayes AT®
<b>Keyboard</b>	82 keys
Function Keys	12 keys
Hot Keys	6 keys
Cursor Control Block	Inverted "T"
Key Travel	3.5mm
<b>Mouse</b>	2 button, 400 DPI
Connection	PS/2, 24" cable
<b>Battery</b>	NiCad High Energy/Density, two units included
Voltage	12 V DC
Current	1.4 AH
Capacity (dual battery pack)	Up to 6 hours
<b>AC Power Supply</b>	
Input Voltage	100-240V AC
Frequency	50/60 Hz
Output Voltage	16V DC
Type	Switching, auto ranging
<b>Software (preloaded)</b>	MS-DOS 4.01 Ver. 1.1 Microsoft Windows 3.0a Productivity Pack Access PLUS TourGuide system tutorial
<b>Operating Environment</b>	
Operating Temperature	50 F to 95 F (10 C to 35 C)
Storage Temperature	-4 F to 140 F (-20 C to 60 C)
Relative Humidity	80% maximum
<b>Size</b>	
Width	12 inches
Depth	9.5 inches
Height	1.8 inches
Volume	205 cu. in.
<b>Weight</b>	
Without Batteries	5.7 pounds
With 1 Battery	6.5 lbs (3 hrs)
With 2 Batteries	7.3 pounds (6 hrs)